

Better Homes and Gardens®

FEBRUARY 2013
BHG.COM \$3.99

4
Ways to
Jump-Start
Your Garden

Easy, Livable

COLOR

Find the
Perfect Hue
Bring Your
Rooms Alive

Express
Your Style

Easy Dinners
Right from the
Freezer p. 107

Simple
Makeover
Secrets p. 53

Chocolate!
Little Bites of
Wonderful

Something Blue

This homeowner's love of turquoise runs so deep, her husband vowed at their wedding to live with the color all the days of his life.

BY KATHY BARNES | PHOTOS KIM CORNELISON
PRODUCED BY JENNY O'CONNOR



A countertop-to-ceiling backsplash of glass mosaic tiles in this cheerful kitchen sets off vibrant accents, including an antique soda siphon.



Accented with a backsplash to match the main wall, a set of 12-inch-deep cabinets, *left*, holds entertaining supplies. Adam poured the concrete counters, *bottom*, tinting the concrete brown for a soft-looking finish.

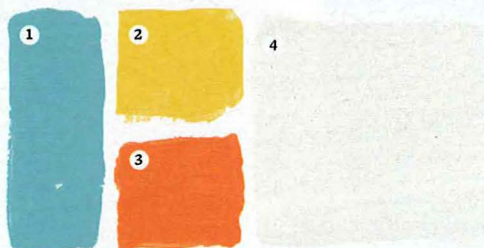
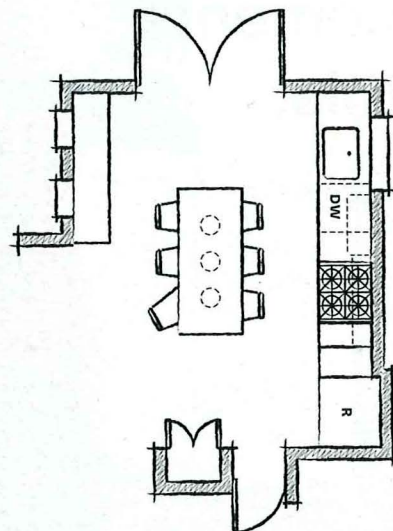

Palette pointers

Backsplash tile establishes turquoise (1) as the kitchen's backdrop. The island pulls in the color to complete its dominant role. Cabinets in can't-go-wrong white (4) provide long-lasting appeal and balance the boldness. Movable accents, such as dinnerware, in citrus hues of yellow (2) and orange (3) add zest to the cool scheme. Their equal intensity is key to the palette's strength.





Adam Talianchich and Ashley Menger (with daughter Gia, below) paired IKEA cabinets with vintage finds. Ashley spotted the lab table on Craigslist, previously using it as a desk/sewing table.

An all-white kitchen was the original plan when Ashley Menger and Adam Talianchich built their house. “We were thinking of resale,” says Ashley, who with her husband owns an Austin design-build firm. “But that didn’t last long. At some point, you want to just live in your house and enjoy it. For me, that meant living with turquoise.”

Ashley has always been fond of the shade because it reminds her of her grandma’s beach house. “I didn’t realize what an influence she was until one day I was looking at my stuff, and there it was—turquoise everywhere,” she says.

To renew her commitment to the color, Ashley chose it for a glass tile backsplash. “I love how it works as a background for my enamelware, especially the orange,” she says.

Equally striking is an old science lab table used as an island. “We wanted to give this new kitchen a sense of history, which meant adding a few things with personality,” Ashley says. “The table had that character.”

